

Specification

Nominal Voltage	12V	
Nominal Capacity(20HR)	60.0AH	
Dimension	Length	255±1mm (10.0 inches)
	Width	170±1mm (6.69 inches)
	Container Height	174.5±1.5mm (6.87 inches)
	Total Height (with Terminal)	177.5±1.5mm (6.99 inches)
Approx Weight	Approx 19.5 kg (43.0lbs)	
Terminal	T6	
Container Material	ABS	
Rated Capacity	60.0 AH/3.00A	(20hr, 1.80V/cell, 25°C/77°F)
	55.4 AH/5.54A	(10hr, 1.80V/cell, 25°C/77°F)
	48.5 AH/9.70A	(5hr, 1.75V/cell, 25°C/77°F)
	42.9 AH/14.3A	(3hr, 1.75V/cell, 25°C/77°F)
	35.6 AH/35.6A	(1hr, 1.60V/cell, 25°C/77°F)
Max. Discharge Current	600A (5s)	
Internal Resistance	Approx 8.2mΩ	
Operating Temp. Range	Discharge : -20~55°C (-4~131°F)	
	Charge : 0~40°C (32~104°F)	
	Storage : -20~50°C (-4~122°F)	
Nominal Operating Temp. Range	25±3°C (77±5°F)	
Cycle Use	Initial Charging Current less than 12A.	
	Voltage 14.1V~14.4V (14.1V is optimum) at 25°C(77°F).	
Standby Use	No limit on Initial Charging Current .Voltage 13.5V~13.8V	
	(13.5V is optimum) at 25°C(77°F) . Coefficient -18mV/°C	
Capacity affected by Temperature	40°C (104°F)	103%
	25°C (77°F)	100%
	0°C (32°F)	86%
Self Discharge	GEL series batteries may be stored for up to 9 months	
	at 25°C(77°F) and then a freshening charge is required. For higher temperatures the time interval will be shorter.	



Applications

- ◆ Railway and marine systems
- ◆ Electric tools
- ◆ Vehicle in place of walking
- ◆ Lawn mowers
- ◆ Golf trolleys and golf cart
- ◆ Electric toys
- ◆ Portable power
- ◆ Wheelchairs
- ◆ Medical equipments.



Constant Current Discharge (Amperes) at 25 °C (77°F)

F.V/Time	10min	15min	20min	30min	45min	1h	2h	3h	4h	5h	6h	8h	10h	20h
1.85V/cell	67.8	58.7	52.8	42.0	32.0	26.7	16.8	12.6	10.3	8.86	7.68	6.20	5.26	2.93
1.80V/cell	81.5	67.9	60.1	46.8	35.9	29.7	18.2	13.6	11.1	9.41	8.15	6.54	5.54	3.00
1.75V/cell	94.5	77.3	66.8	51.0	38.3	31.4	19.1	14.3	11.5	9.70	8.41	6.70	5.62	3.04
1.70V/cell	105.0	84.1	71.6	54.0	40.0	32.8	20.0	14.7	11.8	9.98	8.64	6.85	5.71	3.09
1.67V/cell	112.4	88.4	74.7	56.1	41.6	34.0	20.6	15.2	12.1	10.2	8.81	6.95	5.80	3.13
1.60V/cell	122.5	94.6	79.9	59.4	43.9	35.6	21.3	15.7	12.5	10.5	9.01	7.05	5.89	3.16

Constant Power Discharge (Watts/cell) at 25 °C (77°F)

F.V/Time	10min	15min	20min	30min	45min	1h	2h	3h	4h	5h	6h	8h	10h	20h
1.85V/cell	127.4	111.2	100.8	80.8	61.9	51.9	32.7	24.7	20.3	17.4	15.2	12.3	10.5	5.85
1.80V/cell	150.8	126.6	113.1	89.1	69.0	57.4	35.3	26.5	21.6	18.5	16.1	13.0	11.0	5.99
1.75V/cell	172.3	142.4	124.5	96.3	73.1	60.5	36.9	27.7	22.5	19.0	16.5	13.2	11.1	6.07
1.70V/cell	188.6	153.5	132.5	101.4	76.1	62.9	38.6	28.6	23.0	19.5	17.0	13.5	11.3	6.16
1.67V/cell	199.6	159.5	137.0	104.6	78.6	64.8	39.5	29.3	23.5	19.9	17.3	13.7	11.5	6.22
1.60V/cell	213.7	168.2	145.1	109.7	82.4	67.5	40.7	30.1	24.1	20.4	17.6	13.9	11.6	6.27

Dimensions

T6 Terminal

Unit: mm [inches]

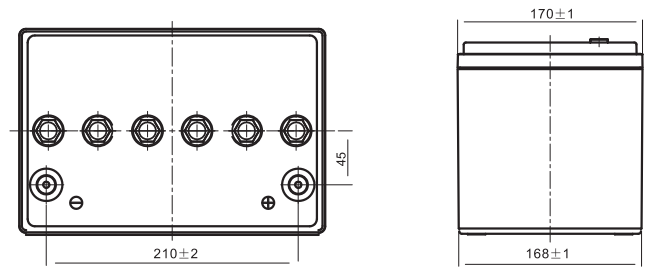
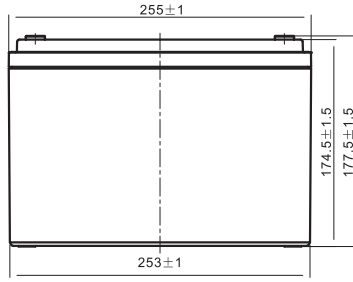
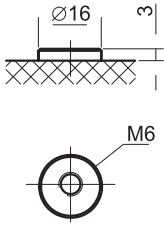

Discharge Characteristics

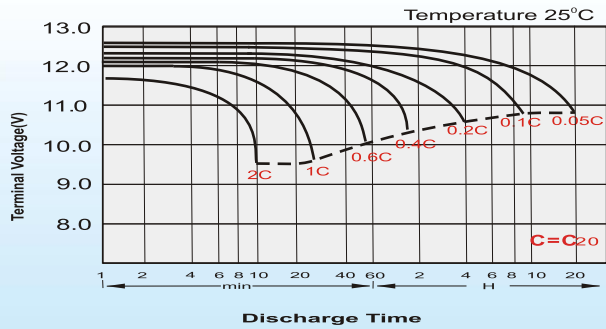

Charging Characteristics (cycle use)

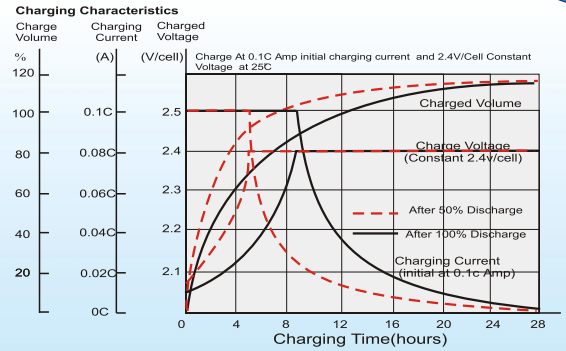

Temperature Effects in Relation to Battery Capacity

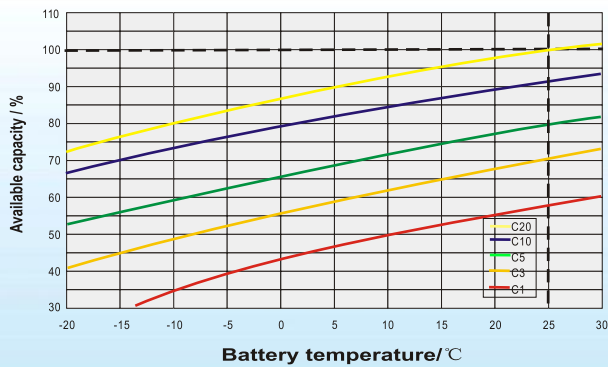

Cycle Life in Relation to Depth of Discharge

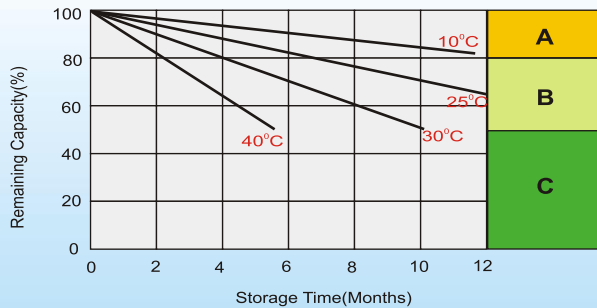
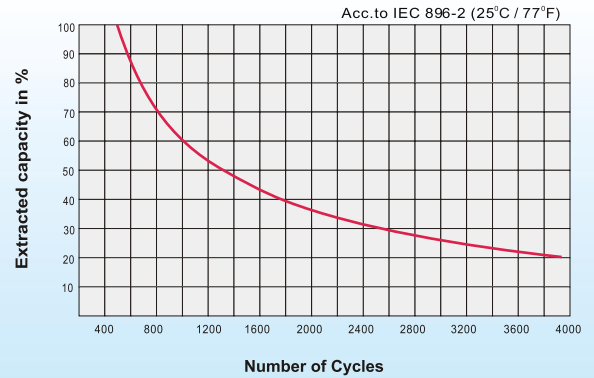

Self Discharge Characteristics

- A** No supplementary charge required
(Carry out supplementary charge before use if 100% capacity is required.)
- B** Supplementary charge required before use. Optional charging way as below:
 1. Charged for above 3 days at limited current 0.25CA and constant volatge 2.25V/cell.
 2. Charged for above 20hours at limited current 0.25CA and constant volatge 2.45V/cell.
 3. Charged for 8~10hours at limited current 0.05CA .
- C** Supplementary charge may often fail to recover the capacity.
The battery should never be left standing till this is reached.

Sales Office

Sweden

Cell tech AB,
Äggelundavägen 2, 175 1 2 Järfälla, Sweden
TEL: +41 8 445 7870
FAX: +41 8 445 7878
E-mail: order@celltech.se
www.celltech.se

Finland and Baltic countries

Celltech oy
Höyläämötie 11A, 00380 Helsinki, Finland
TEL: +358 (0)207 999 1 40
FAX: +358 (0)207 999 1 41
E-mail: info@celltech.fi
www.celltech.fi

Deemark

Celliech A/S
Lejrvej 25, 3500 Vaerloese Denmark
TEL: +45 7025 2201
FAX: +45 7025 2202
E-mail: info@celliech.dk
www.celliech.dk