

Specification

Code:460-6133

Nominal Voltage	12V	
Nominal Capacity(10HR)	135.0AH	
Dimensions	Length	345±3mm (13.6 inches)
	Width	172±2mm (6.77 inches)
	Container Height	274±3mm (10.79 inches)
	Total Height (with Terminal)	280±3mm (11.02 inches)
Approx Weight	Approx 41.2 kg (90.8lbs)	
Terminal	T11	
Container Material	ABS	
Rated Capacity	140.4 AH/7.02A	(20hr, 1.80V/cell, 25°C/77°F)
	135.0 AH/13.5A	(10hr, 1.80V/cell, 25°C/77°F)
	116 AH/23.2A	(5hr, 1.75V/cell, 25°C/77°F)
	105.3 AH/35.1A	(3hr, 1.75V/cell, 25°C/77°F)
	82.4 AH/82.4A	(1hr, 1.60V/cell, 25°C/77°F)
Max. Discharge Current	1350A (5s)	
Internal Resistance	Approx 4.0mΩ	
Operating Temp. Range	Discharge	-15~50°C (5~122°F)
	Charge	0~40°C (32~104°F)
	Storage	-15~40°C (5~104°F)
Nominal Operating Temp. Range	25±3°C (77±5°F)	
Cycle Use	Initial Charging Current less than 40.5A. Voltage	
	14.4V~15.0V at 25°C(77°F)Temp. Coefficient -30mV/°C	
Standby Use	No limit on Initial Charging Current Voltage	
	13.5V~13.8V at 25°C(77°F)Temp. Coefficient -20mV/°C	
Capacity affected by Temperature	40°C (104°F)	103%
	25°C (77°F)	100%
	0°C (32°F)	86%
Self Discharge	Leoch LP series batteries may be stored for up to 6 months at 25°C(77°F) and then a freshening charge is required. For higher temperatures the time interval will be shorter.	



Applications

- ◆ Emergency backup power supply
- ◆ Emergency light
- ◆ Railway signal
- ◆ Aircraft signal
- ◆ Alarm and security system
- ◆ Electronic apparatus and equipment
- ◆ Communication power supply
- ◆ DC power supply
- ◆ Auto control system



Constant Current Discharge (Amperes) at 25 °C (77°F)

F.V/Time	5min	10min	15min	20min	30min	45min	1h	2h	3h	4h	5h	6h	8h	10h	20h
1.85V/cell	231.1	181.7	154.5	129.2	102.7	77.7	63.6	40.5	32.0	26.2	21.1	18.4	14.9	12.7	6.95
1.80V/cell	310.1	232.1	186.7	152.7	121.2	90.4	71.3	44.2	34.5	28.0	22.7	19.7	15.8	13.5	7.02
1.75V/cell	349.7	255.0	203.9	164.3	125.8	93.8	74.6	45.9	35.1	28.6	23.2	20.3	16.1	13.6	7.09
1.70V/cell	385.1	278.0	217.7	172.7	130.9	97.6	76.9	47.7	36.1	29.3	23.8	20.7	16.3	13.8	7.22
1.65V/cell	424.6	300.0	231.4	183.5	138.1	100.0	79.5	49.0	37.6	30.3	24.5	21.1	16.6	14.1	7.32
1.60V/cell	468.3	325.7	247.5	195.4	145.8	104.2	82.4	50.7	38.8	31.3	25.3	21.6	16.7	14.2	7.36

Constant Power Discharge (Watts) at 25 °C (77°F)

F.V/Time	5min	10min	15min	20min	30min	45min	1h	2h	3h	4h	5h	6h	8h	10h	20h
1.85V/cell	422.5	335.6	288.3	243.6	195.7	149.4	122.8	78.7	62.5	51.2	41.4	36.1	29.5	25.2	13.8
1.80V/cell	561.0	423.7	343.6	283.7	227.4	172.4	136.8	85.3	66.9	54.4	44.2	38.6	31.1	26.7	13.9
1.75V/cell	619.1	458.1	370.7	302.2	234.2	177.2	142.4	88.2	67.8	55.4	45.2	39.5	31.6	26.9	14.0
1.70V/cell	662.8	488.0	390.3	315.3	242.4	183.6	146.5	91.5	69.6	56.7	46.3	40.3	32.0	27.2	14.3
1.65V/cell	720.6	521.8	411.8	332.4	253.6	186.5	150.3	93.5	72.2	58.5	47.4	41.1	32.4	27.7	14.4
1.60V/cell	776.4	553.6	433.1	350.2	265.8	193.3	154.8	96.2	74.1	60.1	48.8	41.8	32.7	27.9	14.5

Specifications subject to change without notice.

Dimensions

T11 Terminal

Unit: mm

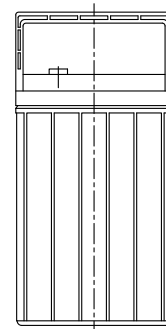
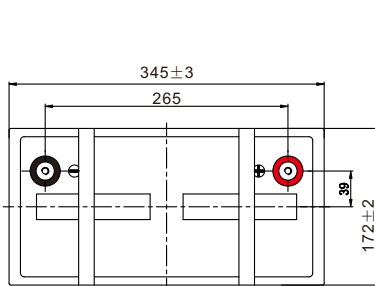
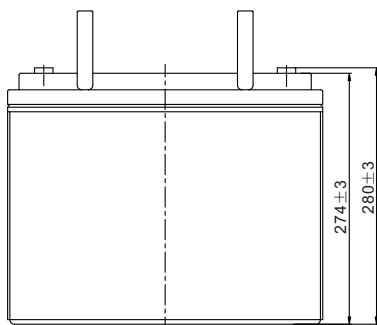
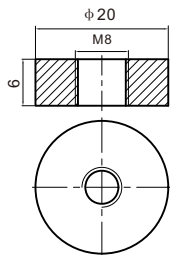

Discharge Characteristics

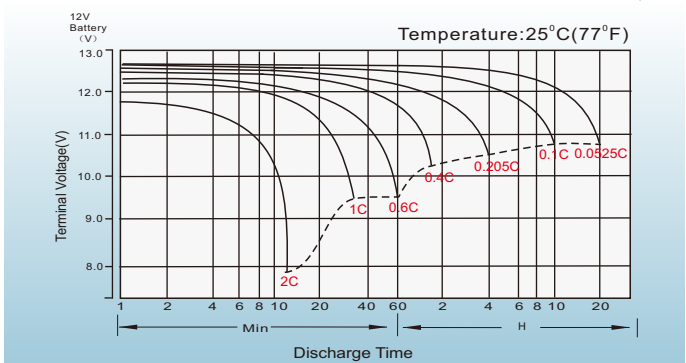

Float Charging Characteristics

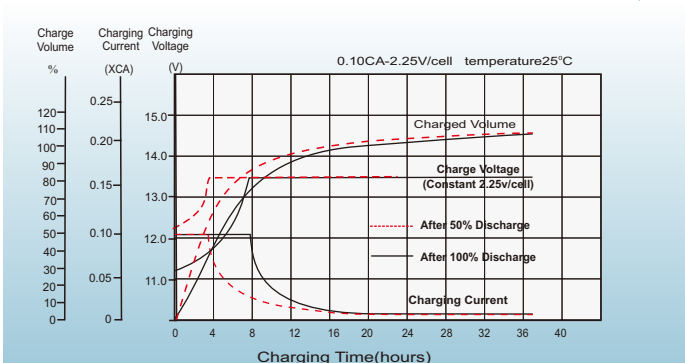

Temperature Effects in Relation to Battery Capacity

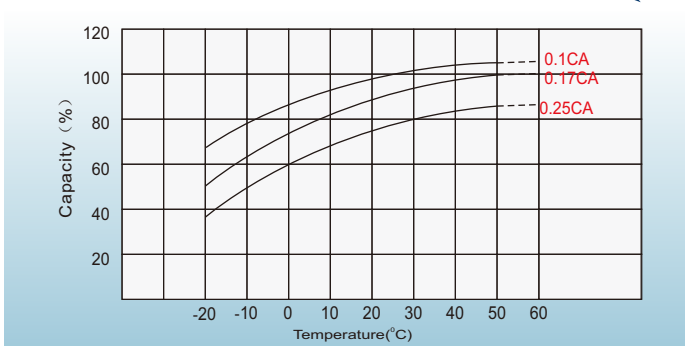

Effect of Temperature on Long Term Float Life

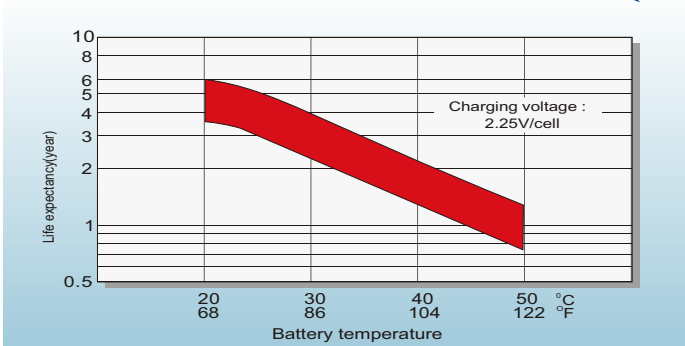

Cycle Life in Relation to Depth of Discharge

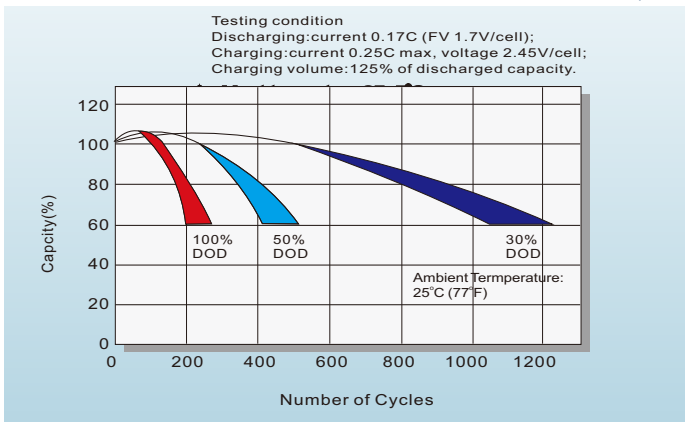

Self Discharge Characteristics

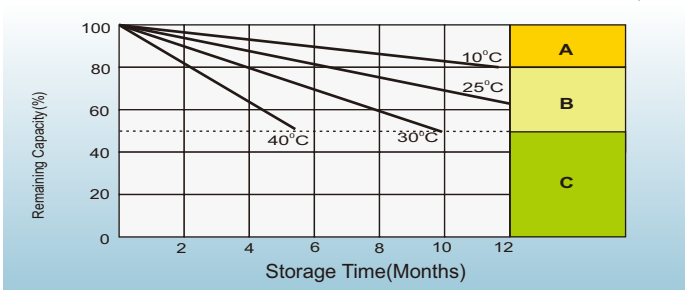

- A** No supplementary charge required (Carry out supplementary charge before use if 100% capacity is required.)
- B** Supplementary charge required before use. Optional charging way as below:
1. Charged for above 3 days at limited current 0.25CA and constant voltage 2.25V/cell.
2. Charged for above 20 hours at limited current 0.25CA and constant voltage 2.45V/cell.
3. Charged for 8-10 hours at limited current 0.05CA.
- C** Supplementary charge may often fail to recover the capacity. The battery should never be left standing till this is reached.

Sales Offices

Finland and Baltic countries
Celltech Oy
Höyläämötie 11 A, 00380 Helsinki, Finland
TEL: +358 (0) 207 999 640
E-mail: info@celltech.fi
www.celltech.fi

Denmark
Celltech A/S
Lejrvej 25, 3500 Værløse, Denmark
TEL: +45 7025 2201
E-mail: info@celltech.dk
www.celltech.dk

Norway
Staubo Elektro-Maskin AS
Bjøernerudveien 12 C, 1266 Oslo, Norway
TEL: +47 22 75 35 00
E-Mail: post@staubo.no
www.staubo.no